



Alaska Alcoholic Beverage Control Board Form AB-00: New License Application

Why is this form needed?

This application for a license is required for all individuals or entities seeking to apply for a new alcoholic beverage license. Applicants should review **Title 04 of Alaska Statutes** and **Chapter 305 of the Alaska Administrative Code**. All fields of this form must be completed, per AS 04.11.260 and 3 AAC 305.045.

This form must be completed and submitted to AMCO's Anchorage office, along with all other required forms and fees before any license application will be considered complete and placed in the queue for a licensing examiner review.

Section 1 – Establishment and Contact Information

Enter information for the business seeking to be licensed.

Applicant:	Gogi, LLC				
License Type:	Restaurant or Eating Place	Statutory Reference:	04.09.210		
Doing Business As:	Gogi Korean BBQ				
Premises Address:	7780 Old Seward Hwy				
City:	Anchorage	State:	Alaska	ZIP:	99518
Local Governing Body/Bodies:	Municipality of Anchorage				
Community Council, (If applicable):	Taku/Campbell				

Mailing Address:	7780 Old Seward Highway				
City:	Anchorage	State:	Alaska	ZIP:	99518

Designated Individual with Binding Authority to apply for this License:	Hyon Yun				
Contact Phone:	907-227-8197	Business Phone:	907-227-8197		
Contact Email:	helenas62@yahoo.com				

Seasonal License? Yes No If "Yes", write your operating period not exceeding Six months each year: _____

OFFICE USE ONLY				
Complete Date:		License Years:		License #:
Board Meeting Date:		Transaction #:	100804881	
Issue Date:		Examiner:		



Alaska Alcoholic Beverage Control Board

Form AB-00: New License Application

Section 2 – Premises Information

Premises to be licensed

- an existing facility a new building a proposed building

The next two questions must be completed by an applicant for a beverage dispensary or beverage dispensary tourism license and package store applicant only:

What is the distance of the shortest pedestrian route from the public entrance of the building of your proposed premises to the outer boundaries of the nearest school grounds? Include the unit of measurement in your answer.

What is the distance of the shortest pedestrian route from the public entrance of the building of your proposed premises to the public entrance of the nearest church building? Include the unit of measurement in your answer.

Section 3 – Sole Proprietor Ownership Information

This section must be completed by any sole proprietor who is applying for a license. Entities should skip to Section 4.

If more space is needed, please attach a separate sheet with the required information.

The following information must be completed for each licensee and each affiliate (spouse).

This individual is an: applicant affiliate

Name:					
Address:					
City:		State:		ZIP:	
Email:		Phone Number:			

This individual is an: applicant affiliate

Name:					
Address:					
City:		State:		ZIP:	
Email:		Phone Number:			



Alaska Alcoholic Beverage Control Board

Form AB-00: New License Application

Section 4 – Entity Ownership Information

This section must be completed by any entity, including a corporation, limited liability company (LLC), partnership, or limited partnership, that is applying for a license. Sole proprietors should skip to Section 5.

If more space is needed, please attach a separate sheet with the required information.

- If the applicant is a corporation, the application shall be executed by an authorized officer of the Corporation. Information must be completed below for each *stockholder who owns 10% or more* of the stock in the corporation, and for each *president, vice-president, secretary, and managing officer*.
- If the applicant is a limited liability organization, whether manager managed or member managed, the following information must be completed for each *member with an ownership interest of 10% or more* and for each *manager regardless of ownership share*.
- If the applicant is a partnership, including a limited partnership, the following information must be completed for each *partner with an interest of 10% or more*, and for each *general partner*.
- For any entity, identify all affiliates for your organization as defined at 3 AAC 305.950.

Entity Official:	Hyon Yun				
Title(s):	Manager, Member	Phone:	907-227-8197	% Owned:	100
Address:	3298 Morgan Loop				
City:	Anchorage	State:	Alaska	ZIP:	99516
Email:	helenas62@yahoo.com				

Entity Official:					
Title(s):		Phone:		% Owned:	
Address:					
City:		State:		ZIP:	
Email:					

Entity Official:					
Title(s):		Phone:		% Owned:	
Address:					
City:		State:		ZIP:	

Entity Official:					
Title(s):		Phone:		% Owned:	
Address:					
City:		State:		ZIP:	



Alaska Alcoholic Beverage Control Board

Form AB-00: New License Application

This subsection must be completed by any applicant that is a corporation or LLC or who has registered as a business entity with the Division of Corporations, Business, and Professional Licensing (CBPL). Any entity registered or required to be registered with CBPL must be in good standing and have a registered agent as defined at AS 04.11.430.

CBPL Entity #:	10265228	AK Formed Date:	04.01.2024	Home State:	Alaska
Registered Agent:	Jana Weltzin		Agent's Phone:	907-231-3750	
Agent's Mailing Address:	901 Photo Avenue, Second Floor				
City:	Anchorage	State:	Alaska	ZIP:	99503
Email:	jana@jdwounsel.com				

Does your registered agent satisfy the requirement of AS 04.11.430? Yes No

Section 5 - Other Licenses

Ownership and financial interest in other alcoholic beverage businesses. Yes No

Does any representative or owner named in this application have any direct or indirect financial interest in any other alcoholic beverage business that does business in or is licensed in Alaska?

If "Yes", disclose which individual(s) has the financial interest, what the type of business is, and if licensed in Alaska, which license number(s) and license type(s):

Section 6 - Authorization

Communication with AMCO staff: Yes No

Does any person other than a licensee named in this application have authority to discuss this license with AMCO staff?

If "Yes", disclose the name of the individual and contact information for the individual, including phone number and email, and the authority for this authorization:

Attorney Jana Weltzin and Staff - 907-231-3750, Jana@jdwounsel.com, Brenda@jdwounsel.com, Randi@jdwounsel.com



Alaska Alcoholic Beverage Control Board Form AB-00: New License Application

Section 7 – Attestations

Read each line below, and then sign your initials in the box to the right of each statement:

Initials

I certify that all proposed licensees (as defined in AS 04.11.260) and affiliates have been listed on this application.

HY

I certify that I understand that providing a false statement on this form or any other form provided by AMCO is grounds for rejection or denial of this application or revocation of any license issued.

HY

I certify that all licensees, agents, and employees who sell or serve alcoholic beverages or check the identification of a patron will complete an approved alcohol server education course, if required by AS 04.21.025, and, while selling or serving alcoholic beverages, will carry or have available to show a current course card or a photocopy of the card certifying completion of approved alcohol server education course, if required by 3 AAC 305.700.

HY

I agree to provide all information required by the Alcoholic Beverage Control Board in support of this application.

HY

I hereby certify that I am the person herein named and subscribing to this application and I know the full content thereof. I declare that all of the information contained herein, and evidence or other documents submitted are true and correct. I understand that any falsification or misrepresentation of any item or response in this application, or any attachment, or documents to support this application, is sufficient grounds for denying or revoking a license/permit. I further understand that it is a Class A misdemeanor under Alaska Statute 11.56.210 to falsify an application and commit the crime of unsworn falsification.

HY

I certify that all proposed licensees have been listed with Division of Corporation, Business and Professional Licensing.

HY

I certify that I and any individual identified in the business entity ownership section of this application, has or will read AS 04 and its implementing regulations.

HY

Hyon Yun

Printed name of licensee

Signature of licensee



Alaska Alcoholic Beverage Control Board

Form AB-02: Premises Diagram

Why is this form needed?

A detailed diagram of the proposed licensed premises is required for all alcohol license applications, per AS 04.11.260, 3 AAC 305.630 and 3 AAC 305.660. Your diagram must include dimensions and must show all entrances and boundaries of the premises, walls, bars, fixtures, and areas of storage, service, consumption, and manufacturing.

This form must be completed and submitted to AMCO's Anchorage office before any license application will be considered complete. You may attach blueprints or other detailed drawings that meet the requirements of this form.

The diagram MUST include:

- You must use a **solid, contiguous red line** to outline the outer perimeter of your premises with no breaks or separations.
 - The red outline is required to follow a physical barrier (wall, fence and even across doorways).
 - There should be no red lines within the perimeter
- Each area should be clearly labeled in any color other than red where alcohol is:
 - Stored
 - Served/Sold
 - Manufactured
 - Consumed
- All diagrams must include:
 - Dimensions (AMCO does not accept diagrams drawn to scale)
 - Cross streets
 - Points of reference, such as a compass rose indicating True North
 - All entrances, exits, walls, bars, and fixtures
- If your premises include multiple floors, please include a separate diagram of each floor.
 - You must identify the stairs between each floor, and each hallway/corridor that leads to each set of stairs.
- If your premises includes multiple floors, please include a separate diagram of each floor. You must identify the stairs between each floor, and each hallway/corridor that leads to each set of stairs.
- If your proposed premises is located within a building or building complex that contains multiple businesses and/or tenants, please provide an additional page that clearly shows the location of your proposed premises within the building or building complex, along with the addresses and/or suite numbers of the other businesses and/or tenants within the building or building complex.
- **Any license applications that include outdoor space** are required to submit a security plan that includes information about the barriers, practices, and personnel that are to be used to ensure that alcohol is not introduced or removed from the permitted premises and to prevent the access of alcohol by a minor during the permitted event. A security plan may be requested for other proposed locations on a case-by-case basis.

Section 1 – Establishment Information

Enter information for the business seeking to be licensed, as identified on the license application.

Licensee:	Gogi, LLC	License Number:	6216		
License Type:	Restaurant or Eating Place				
Doing Business As:	Gogi Korean BBQ				
Premises Address:	7780 Old Seward Hwy				
City:	Anchorage	State:	Alaska	ZIP:	99518



Alcohol and Marijuana Control Office
550 W 7th Avenue, Suite 1600
Anchorage, AK 99501
alcohol.licensing@alaska.gov
<https://www.commerce.alaska.gov/web/amco>
Phone: 907.269.0350

Alaska Alcoholic Beverage Control Board
Form AB-02: Premises Diagram

Section 2 – Detailed Premises Diagram

Clearly indicate the boundaries of the premises and the proposed licensed area within that property. See above for detailed instructions.

A large, empty rectangular box with a black border, intended for the user to draw the premises and licensed area boundaries.

Gezi Korean BBQ
7780 Old Seward Highway
License#

→ True North

- Licensed Premises
- Alcohol served/Sold and Consumed

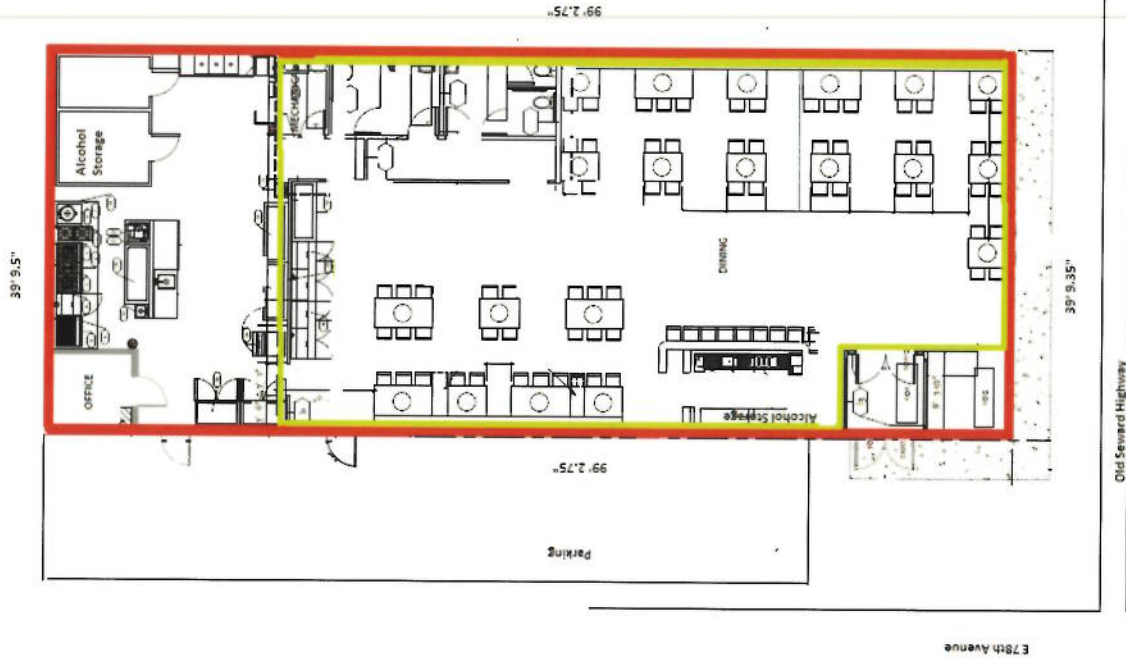

Received 5/24/24



Alaska Alcoholic Beverage Control Board

Restaurant Endorsement Application

The new endorsement application form is required to apply for a restaurant endorsement to support your underlying license or pending license application. Applicants should review and become familiar with AS 04.09.450, Title 04 of Alaska Statutes and Chapter 305 of the Alaska Administrative Code. This form must be completed and submitted along with all other required forms and documents before any endorsement application will be considered complete and placed in the queue for our licensing examiners review.

Section 1 – Establishment and Contact Information

Enter information for the **current** licensee and licensed establish.

Licensee:	Gogi, LLC	License #:		
License Type:	Restaurant or Eating Place	Doing Business As:	Gogi Korean BBQ	
Licensee Mailing Address:	7780 Old Seward Hwy Anchorage, Alaska 99518			
Full Premises Address:	7780 Old Seward Hwy			
City:	Anchorage	State:	Alaska	ZIP: 99518
Local Governing Body:	Municipality of Anchorage / Taku Campbell CC	Email:	helenas62@yahoo.com	

Section 2 – Endorsement Requested

Restaurant Endorsement:	AS 04.09.450. A restaurant endorsement authorizes the holder of a beverage dispensary license, fair license, golf course license, sporting activity or event license, club license, outdoor recreation lodge license, destination resort license, or beverage dispensary tourism license. The biennial fee for a restaurant endorsement is \$200 with a \$25 application fee.
--------------------------------	--

An application for a restaurant endorsement must specify the establishment or portion of the establishment that constitutes a bona fide restaurant, that there is supervision on the premises adequate to reasonably ensure that a person under 21 years of age will not obtain alcoholic beverages. This endorsement application is for the request of a designation as a bona fide restaurant, hotel, or eating place for purposes of AS 04.16.010(c) or AS 04.16.049, and for the request of the following designation(s) (check all that apply):

1. Dining after standard closing hours: AS 04.16.010(c)
2. Dining by persons 16 – 20 years of age: AS 04.16.049(a)
3. Dining by persons under the age of 16 years, accompanied by a person over the age of 21: AS 04.16.049(a)
4. Employment for any persons under 21 years of age: AS 04.16.049(c)

NOTE: Under AS 04.16.049(d), a Department of Labor and Workforce Development work permit is not required to employ a person 18 - 20 years of age.

Section 3 – Minor Access

Review AS 04.16.049(a); AS 04.16.049(c)

Be specific in your list where within the premises minors are anticipated to have access in the course of either dining or employment as designated in Section 2. (Example: Minors will only be allowed in the dining area OR minors will only be employed and present in the kitchen).

Minors will be allowed in the dining area and minors will be employed and present in the kitchen. Gogi staff will monitor their assigned areas, greet guests, monitor guests' consumption, and ensure there are no persons under 21 years of age that are not supervised by a parent or guardian. Gogi staff also be responsible to remove any abandoned drinks, empty glasses, and any glass left unattended that has alcoholic beverages in it to ensure minors do not gain access to unattended alcohol. Underage staff will not have access to alcoholic beverages unless they are bussing a table, when they are, they will be supervised by someone over 21.



Alaska Alcoholic Beverage Control Board Restaurant Endorsement Application

Describe the policies, practices and procedures that will be in place to ensure that minors do not gain access to alcohol while dining or employed at your premises. Outline how and where alcohol is stored on premises. Acknowledge that employees who sell and serve alcohol must have a current Server Education Card.

Gogi will ensure that no alcohol is consumed or accessed by a minor in the establishment. All Gogi servers are TAPS certified. All minors must be accompanied by a parent or legal guardian (over age 21) while in the restricted area when any alcohol is being served, sold, or consumed. Underage persons will be monitored closely by our professionally trained alcohol servers. Servers will check the identification of all patrons ordering an alcoholic beverage and keep an eye on tables with minors to ensure they are not drinking alcohol. Proper signage will be posted at all points of entry indicating no minors may enter without a parent or legal guardian. All staff is trained in the identification of fake ID's. Keeping the all serving areas viable without any increased risk to minors exposed to alcohol will continue to be part of our training for our staff. All servers will closely monitor that only the guests that have been carded will have alcoholic beverages.

Is an owner, manager, or assistant manager who is 21 years of age or older always present on the premises during business hours?

Yes No

Section 4 – ADEC Food Service Permit

Per AS 04.21.080(b) for an establishment to qualify as a bona fide restaurant, a Food Service Permit or (for licenses within the Municipality of Anchorage) corresponding Department of Health and Human Services documentation is required.

Link to the Alaska Department of Environmental Conservation (ADEC) Food Safety Website:
<http://dec.alaska.gov/eh/fss/food/>

Link to the Municipality of Anchorage Food Safety Website:
<http://www.muni.org/Departments/health/Admin/environment/FSS/Pages/fssfood.aspx>

IF you are unable to certify the below statement, please discuss the matter with the AMCO office:

Initials

I have attached a copy of the current food service permit for this premises OR the plan review approval.

**Note: If a plan review approval is submitted, a final permit will be required before finalization of any permit or license application.*

Section 5 – Hours of Operation

Review AS 04.16.010(c).

Include variances in weekend/weekday hours, and indicate AM/PM:

Days/Hours of Operation

Weekday	Hours	Hours
Sunday	11:00AM	12:00AM
Monday	11:00AM	12:00AM
Tuesday	11:00AM	12:00AM
Wednesday	11:00AM	12:00AM
Thursday	11:00AM	12:00AM
Friday	11:00AM	12:00AM
Saturday	11:00AM	12:00AM



Alaska Alcoholic Beverage Control Board Restaurant Endorsement Application

Section 6 – Areas Covered by Endorsement

Does the endorsement apply to your entire licensed premises as approved by the ABC Board? Yes No

Does the requested endorsement expand your currently licensed premises? Yes No

- If No, attach the approved diagram, no larger than 8 1/2" x 11" of the layout, and identify the portions of the premises covered by various requested endorsements. You must use a solid, contiguous colored line in any color other than red to outline the outer perimeter of the area of the premises covered by the requested endorsement(s).
- If endorsements are overlapping, provide a conspicuous means to distinguish each endorsement from the other (e.g., keyed map with varying colors for each requested endorsement).
- Your drawing MUST include:
 - Dimensions in feet **not** square feet of all exterior walls and major interior walls (we do not accept diagrams drawn to scale)
 - Include cross-streets
 - A north arrow, and any significant geographical features. Points of reference, such as a compass showing North.
 - All entrances, exits, walls, bars, and fixtures
- If your premises includes multiple floors, please include a separate diagram of each floor. You must identify the stairs between each floor, and each hallway/corridor that leads to each set of stairs.
- **Any endorsement applications that include outdoor space** are required to submit a security plan that includes information about the barriers, practices, and personnel that are to be used to ensure that alcohol is not introduced or removed from the permitted premises and to prevent the access of alcohol by a minor during the permitted event. A security plan may be requested for other proposed locations on a case-by-case basis.

Section 7 – Attestations

I certify that I understand that providing a false statement on this form or any other form provided by AMCO is grounds for rejection or denial of this application or revocation of any license issued.

Initials
 HY

I certify that all licensees, agents, and employees who sell or serve alcoholic beverages or check the identification of a patron will complete an approved alcohol server education course, if required by AS 04.21.025, and while selling or serving alcoholic beverages, will carry or have available to show a current course card or a photocopy of the card certifying completion of approved alcohol server education course, if required by 3AAC 305.340.

HY

I agree to provide all information required by the Alcoholic Beverage Control Board in support of this application.

HY

I hereby certify that I am the person herein named and subscribing to this application and that I have read the complete application, and I know the full content thereof. I declare that all of the information contained herein, and evidence of other documents submitted are true and correct. I understand that any falsification or misrepresentation of any item or response in this application, or any attachment, or documents to support this application, is sufficient grounds for denying or revoking a license, and or endorsement. I further understand that this is a Class A misdemeanor under AS 11.56.210 to falsify an application and commit the crime of unsworn falsification.

HY

Hyon Yun

5/08/24

Printed name of licensee

Signature of licensee

Date

COMBOS

COMBO #1 – SERVES 2-3 \$00

Pork Belly, Pork Jowl, and Grilled Bulgogi

COMBO #2 - SERVES 2-3 \$00

Beef Belly, Seasoned Boneless Short Rib,
Grilled Bulgogi, Pork Jowl

WAGYU COMBO- SERVES 2-3 \$00

Wagyu Brisket and Grilled Bulgogi

LARGE COMBO - SERVES 3-4 \$00

Ribeye, Marinated beef short ribs, Grilled
Bulgogi, Beef Belly, Pork Belly and Pork Jowl

JUMBO COMBO SERVES 4-5 \$00

Ribeye, Marinated beef short ribs, Grilled
Bulgogi, Beef Belly, Pork Belly and Pork Jowl,
Shrimp and Scallops

* ALL COMBOS COME WITH VEGETABLE
SKEWERS, KIMCHI, OR SOYBEAN STEW

NOODLE DISHES

SPICY COLD NOODLE \$00

(BIBIM NAENGMYEON)

COLD NOODLE IN CHILLED

BROTH \$00

(NAENGMYEON)

GOGI KOREAN BBQ RESTAURANT

7780 Old Seward Highway
Anchorage, AK 99518

Received 5/24/24

A LA CARTE

MARINATED SHORT RIB \$00

BONELESS SHORT RIB \$00

DRY-AGED PRIME RIBEYE \$00

DRY AGED BONE-IN RIB EYE \$00
(TOMAHAWK)

BEEF BRISKET \$00

PORK BELLY \$00

PORK JOWL \$00

SPICY PORK BELLY \$00

SPICY PORK JOWL \$00

SEAFOOD PANCAKE \$00

SPICY STIR-FRIED SQUID WITH
VEGETABLE \$00

WAGYU A LA CARTE

WAGYU RIBEYE \$00

WAGYU BRISKET \$00

STEW

KIMCHI STEW \$00

SOYBEAN STEW \$00